

Weld on Caps

EXTRA THICK, Carbon Steel

Inches / Pounds

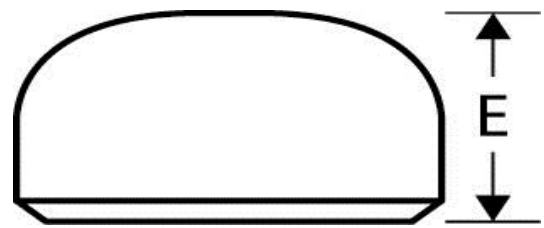

Part #	Nominal Pipe Size	Outside Diameter	Inside Diameter	Wall Thickness	Length (E)	Pipe Schedule	Approximate Weight (in Lbs.)
KCXH.5	1/2	0.84	0.546	0.147	1.00	80	0.1
KCXH.75	3/4	1.050	0.742	0.154	1.25	80	0.16
KCXH1	1	1.315	0.957	0.179	1.50	80	0.28
KCXH1.25	1 1/4	1.660	1.278	0.191	1.50	80	0.48
KCXH1.5	1 1/2	1.900	1.500	0.200	1.50	80	0.67
KCXH2	2	2.375	1.939	0.218	1.50	80	0.92
KCXH2.5	2 1/2	2.875	2.323	0.276	1.50	80	1.3
KCXH3	3	3.500	2.900	0.300	2.00	80	2.1
KCXH3.5	3 1/2	4.000	3.364	0.318	2.50	80	3
KCXH4	4	4.500	3.826	0.337	2.50	80	3.5
KCXH5	5	5.563	4.813	0.375	3.00	80	5.8
KCXH6	6	6.625	5.761	0.432	3.50	80	9.3
KCXH8	8	8.625	7.625	0.500	4.00	80	16
KCXH10	10	10.75	9.750	0.500	5.00	60	26
KCXH12	12	12.75	11.75	0.500	6.00	XS*	38
KCXH14	14	14.00	13.00	0.500	6.50	XS*	47
KCXH16	16	16.00	15.00	0.500	7.00	40	57
KCXH18	18	18.00	17.00	0.500	8.00	XS*	78
KCXH20	20	20.00	19.00	0.500	9.00	30	100
KCXH22	22	22.00	21.00	0.500	10.00	XS*	115
KCXH24	24	24.00	23.00	0.500	10.50	XS*	145
KCXH26	26	26.00	25.00	0.500	10.50	XS*	175
KCXH30	30	30.00	29.00	0.500	10.50	20	634
KCXH34	34	34.00	33.00	0.500	10.50	XS*	210
KCXH36	36	36.00	35.00	0.500	10.50	20	913
KCXH42	42	42.00	41.00	0.500	12.00	XS*	1,300
KCXH48	48	48.00	47.00	0.500	13.50	XS*	1,675

*** XS* designates Extra Strong (extra strong wall). This size and thickness does not correspond to any pipe schedule number.**

*** Dimensions conform to ASME B16.9 & material conforms to ASTM SA-234 Grade B.**